

English

**iCare** HOME2

# **iCare** HOME2 Quick Guide

Quick Guide

Rx Only (U.S.)

**icare**



Read this Quick Guide and watch the HOME2 user instructions video before using the tonometer. Follow the instructions step by step.



For safety information, read Chapter 1 in the Instruction Manual before using the tonometer.

If you need help in using the iCare HOME2 tonometer, contact your healthcare professional.



**PRECAUTION!** Before taking measurements, update the tonometer's time to your local time manually from the tonometer's settings or automatically by connecting the tonometer to the iCare PATIENT2 application or to the iCare EXPORT software.



Step		Page
<b>1</b>	Inserting the batteries	5
<b>2</b>	Inserting the probe	6
<b>3</b>	Switching on	7
<b>4</b>	Correct measurement position	8
<b>5</b>	Adjusting the supports and positioning the tonometer	9
<b>6</b>	Measuring eye pressure	11
<b>7</b>	Measuring eye pressure in the supine position	13
<b>8</b>	Troubleshooting	16
<b>9</b>	Switching off the tonometer and disposing of the probe	18

## Tonometer parts

4

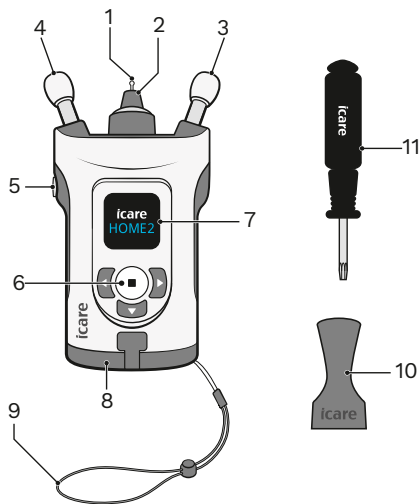

- 1 Probe
- 2 Probe base
- 3 Cheek support
- 4 Forehead support
- 5 Measure button
- 6 Select button
- 7 Display
- 8 Battery cover
- 9 Wrist strap
- 10 Probe applicator
- 11 Screwdriver Torx TX8

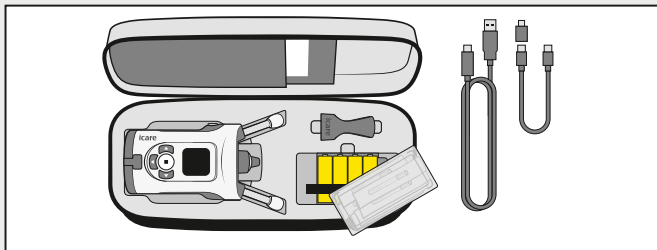

The batteries are in the tonometer carrying case under the box of probes.

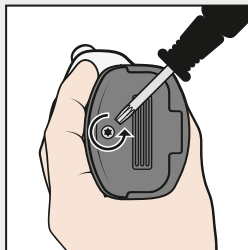

Open the battery cover with the screwdriver.

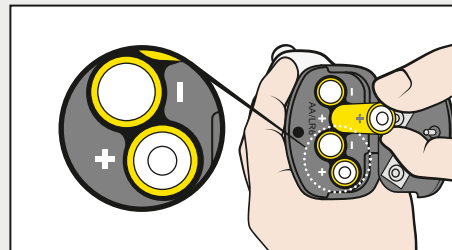

Insert the batteries, and close the cover.

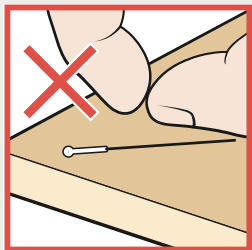

Do not use a probe if it has touched your hand, a table, or other nonsterile surface.

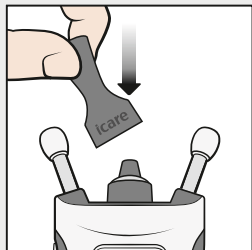

Place the probe applicator over the probe base.

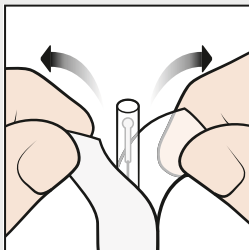

Open the packaging.

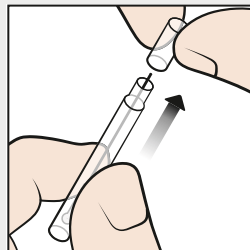

Remove the cap.

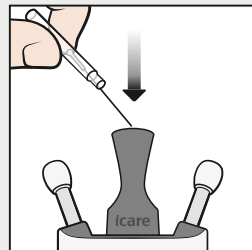

Drop the probe from the container to the probe applicator.



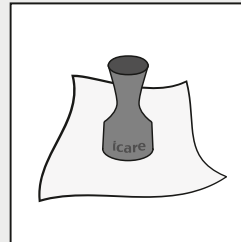
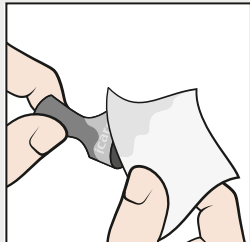
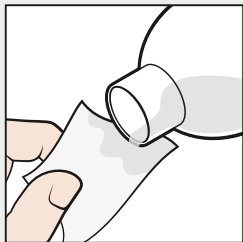
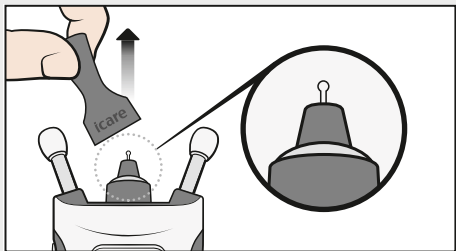

**WARNING!** To prevent contamination, keep unused probes in their box. Do not touch a bare probe. Do not use a probe if it touches a non-sterile surface such as a table or a floor.



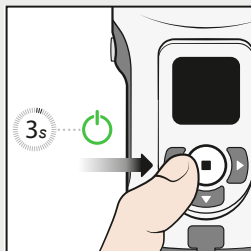
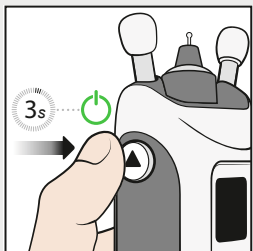

Remove the probe applicator.

To clean the applicator, wipe it with 70% ethanol or 70%-100% isopropyl alcohol or rinse it with sterile purified water and then make sure that it is completely dry before use.



Press down  until you hear a beep. The text “Start” is shown on the display.

Alternatively, press down  until you hear a beep. Then press  again to enter the measurement mode. The text “Start” is shown on the display.



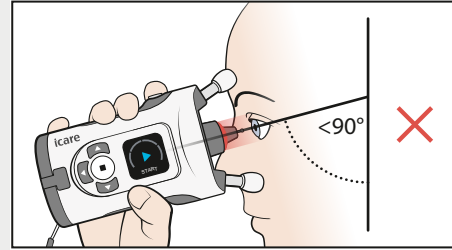
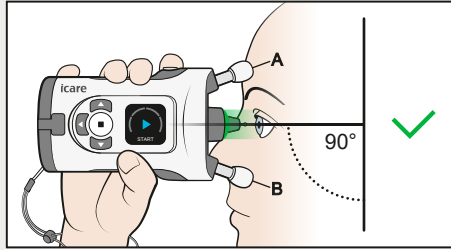
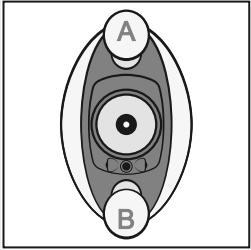

The forehead support A rests on your forehead and the cheek support B rests on your cheek.

Look straight ahead and the tonometer is at a 90-degree angle to your face. The probe is about 3/16 inches from your eye and points perpendicularly to the center of your eye.

If you see a red light in the probe base, the tonometer is tilted too much downwards. You should straighten your posture and lift your chin.

Positioning the tonometer is instructed in the following section.

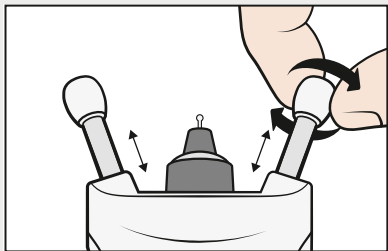

Before the measurement, adjust the forehead and cheek supports to the correct length. Start with the supports at the maximum length.

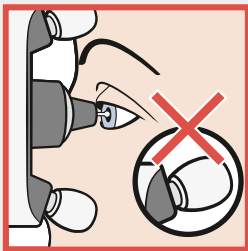

Shorten the supports only two clicks at a time to prevent the tonometer from getting too close to your eye.

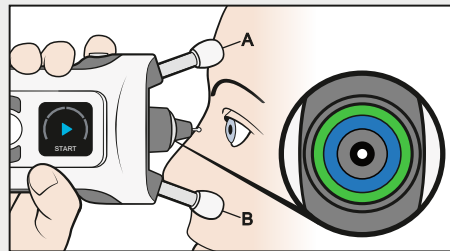

Place the tonometer against your face and look into the probe base. The probe points perpendicularly to the center of your eye when the blue and green rings in the probe base are symmetrical. You can hold the device with one or both hands.



**WARNING!** Only the probe should touch the eye. Do not touch your eye with any other parts of the tonometer. Do not poke your eye with the tonometer.

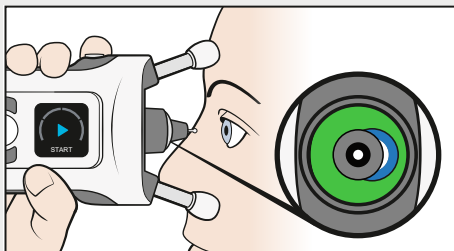

If the rings are not symmetrical, the probe does not point perpendicularly to the center of your eye. Correct the position of the tonometer.

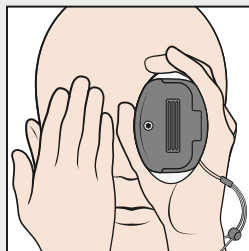

Keep both eyes open. Covering the eye not being tested may help you see the rings more clearly.

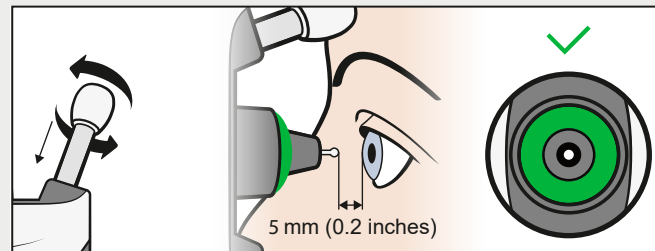

Shorten the supports by rotating them clockwise two clicks at a time until you only see a symmetrical green ring. The tonometer is now at the correct distance from your eye.

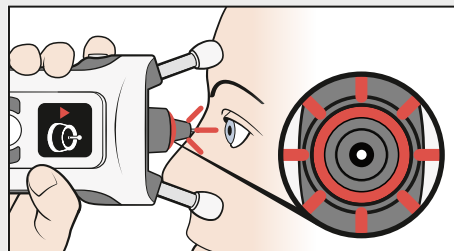
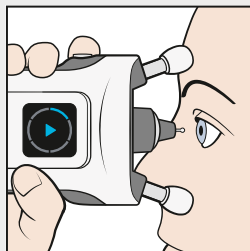
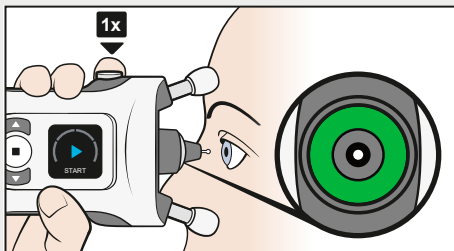

Start the measurement when you see only a symmetrical green ring. Press the Measure button (▶) once. The probe gently touches your eye.

A single beep indicates a successful measurement. Continue taking measurements until you hear a long beep and the light in the probe base turns off.

If the probe base flashes red and you hear multiple beeps, the measurement was not successful. See **Troubleshooting** on page 17.

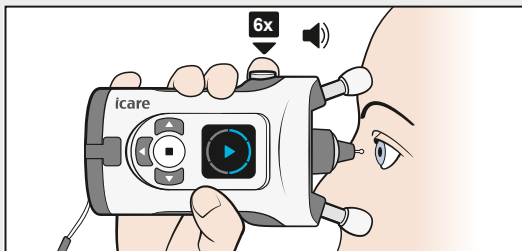

A measurement sequence consists of six measurements.

**Tip:** You can also take the measurement sequence by pressing and holding the Measure button (▶) down until all six measurements have been taken.

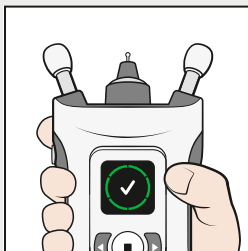

When all six measurements have been successfully taken, you hear a longer beep. The display shows the measurement quality.

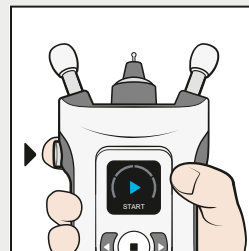

Press the Measure button (▶) once and repeat the measurement on your other eye.

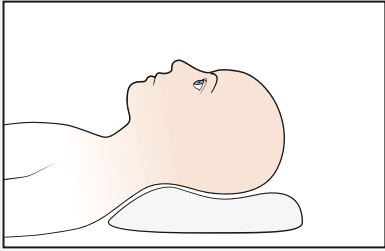

Before measuring, lie down for a moment.

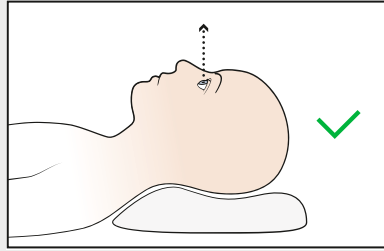

Take a comfortable position on your back with a pillow behind your neck. Look straight ahead.

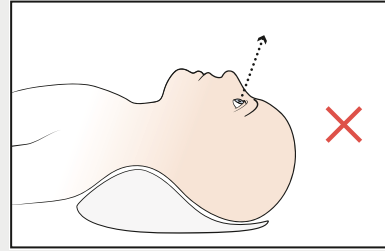

Avoid bending your head backwards.

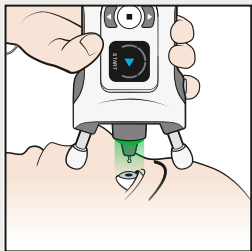

Place the tonometer at a 90 degrees angle on your face and take the measurement as previously instructed.

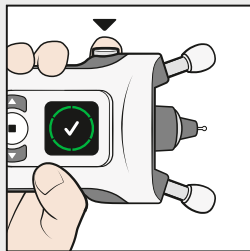

After a successful measurement, press the Measure button (▶) once and repeat the measurement on your other eye.

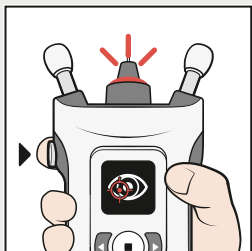

If an error occurs, the probe base flashes red. The display and sounds indicate the source of the error.

Look at the display, press the Measure button (▶) once, make the necessary corrections, and repeat the measurement.

For more explanations of the error messages, see the HOME2 instruction manual.



Icon	Display text	Sound	Problem	Solution
	<b>TOO FAR</b>	3 long 	The probe is too far away from the eye.	Press the Measure button  once to acknowledge the error. Shorten the forehead and cheek supports.
	<b>TOO NEAR</b>	5 short 	The probe is too close to the eye.	Press the Measure button  once to acknowledge the error. Lengthen the forehead and cheek supports.
	<b>INCORRECT ALIGNMENT</b>	2 short 	The probe was not perpendicular to the cornea or the probe hit an eyelid or eyelashes.	Press the Measure button  once to acknowledge the error. Position the tonometer so that the probe points perpendicularly to the center of your eye. Keep your eye properly open.
	<b>REPEAT</b>	2 short 	There was a problem with the movement of the probe.	Press the Measure button  once to acknowledge the error. Repeat the measurement.
	<b>DETECTION ERROR</b>	2 short 	The sensor could not identify the measured eye (right or left).	Press  , then press  until the correct eye (right or left) is shown on the display. Press  , or press the return button to cancel the measurement.

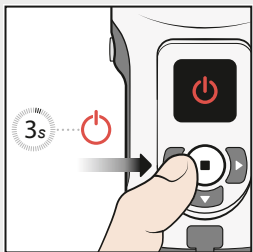

Press and hold the Select button  until you hear 3 beeps and the display switches off.

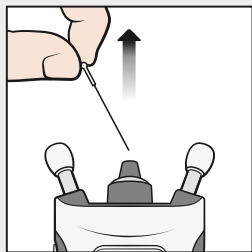

Remove the probe and place it back into the probe container.



Dispose of the probe and the container in a mixed waste bin.

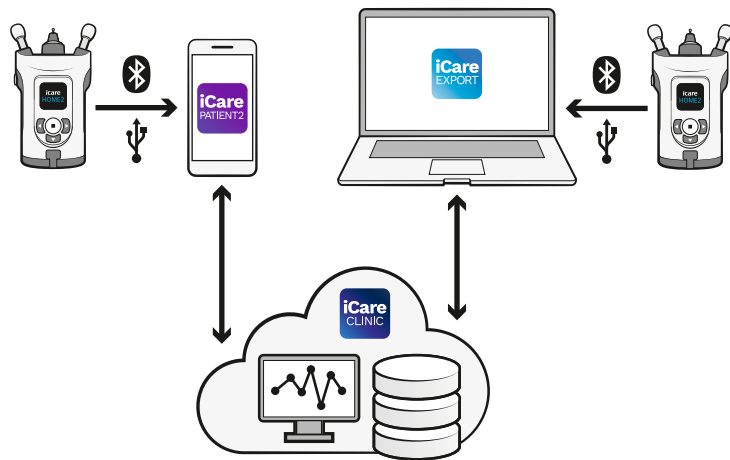

Now you can transfer your measurement results to your doctor's iCare CLINIC or to your private account in the iCare CLOUD by using the iCare PATIENT2 app on your mobile device or the iCare EXPORT software on your computer.

**Icare Finland Oy**

Äyritie 22

01510 Vantaa, Finland

Ph. +358 9 8775 1150

info@icare-world.com

**Icare USA, Inc.**

4700 Falls of Neuse Rd. Ste 245

Raleigh, NC. 27609

Ph. +1 888.422.7313

Fax +1 877.477.5485

infoUSA@icare-world.com



For further information,  
read the instruction manual.

[www.icare-world.com](http://www.icare-world.com)**icare**

iCare is a registered trademark of Icare Finland Oy. Icare Finland Oy, Icare USA, Inc., iCare World Australia Pty Ltd and Centervue S.p.A., are parts of Revenio Group and represent the brand iCare.

Not all products, accessories, services or offers are approved or offered in every market and approved labelling and instructions may vary from one country to another. Product specifications are subject to change in design and scope of delivery and as a result of ongoing technical developments.